

Style 705M | Pipe Clamp



Size Range: 3/4" through 8" (20-300mm)

Material: Carbon steel

Finish: Copper plated

Service: Recommended for support and steadying of copper tube risers, either insulated or non-insulated. This product is not intended for use with hanger rods.

Approvals: Complies with Federal Specification A-A-1192A (Type 8), WW-H-171-E (Type 8), ANSI/MSS SP-69 and MSS SP-58 (Type 8).

Service: For support and steadying of copper tubing risers.

Installation: Clamp is fitted and bolted preferably below a coupling or fitting on the tubing. Do not over tighten bolts.

Features: Rounded ears provide greater safety for personnel.

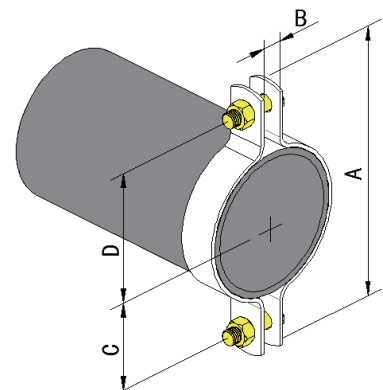

Pipe Size	A	B	C	D	Max Load	Approx. Wt. Ea.
In/mm	In/mm	In/mm	In/mm	In/mm	Lbf/N	Lbs./kg
¾	3.46	0.47	1.10	1.26	500	0.29
20	88.0	12.0	28.0	32.0	2223	0.13
1	3.54	0.47	1.10	1.38	500	0.29
25	90.0	12.0	28.0	35.0	2223	0.13
1¼	4.13	0.47	1.42	1.61	500	0.33
32	105.0	12.0	36.0	41.0	2223	0.15
1½	4.25	0.47	1.57	1.69	800	0.37
40	108.0	12.0	40.0	43.0	3555	0.17
2	5.51	0.47	2.13	2.13	1040	0.90
50	140.0	12.0	54.0	54.0	4620	0.41
2½	6.54	0.63	2.64	2.64	1040	0.97
65	166.0	16.0	67.0	67.0	4620	0.44
3	7.01	0.63	2.87	2.87	1040	1.12
80	178.0	16.0	73.0	73.0	4620	0.51
3½	7.64	0.63	3.19	3.19	1040	1.17
90	194.0	16.0	81.0	81.0	4620	0.53
4	8.50	0.63	3.50	3.50	1040	1.43
100	216.0	16.0	89.0	89.0	4620	0.65
5	9.84	0.75	4.17	4.17	1040	2.54
125	250.0	19.0	106.0	106.0	4620	1.15
6	11.50	0.75	4.88	4.88	1615	4.50
150	292.0	19.0	124.0	124.0	7178	2.04
8	13.78	0.75	5.98	5.98	1615	5.45
200	350.0	19.0	152.0	152.0	7178	2.47
10	17.09	0.98	7.44	7.44	2490	10.71
250	434.0	25.0	189.0	189.0	11065	4.86
12	19.13	0.98	8.43	8.43	2490	13.56
300	486.0	25.0	214.0	214.0	11065	6.15



Shanghai Vision Mechanical Joint Ltd., Co.,

Address: Jinlan Rd. 221, Jiading Industrial Park, Shanghai, China

Tel: 0086-21-5954-6862, 5954-6811, Fax: 0086-21--5954-3888 Web: www.visionmfr.com

D-1043E